



Safety. Customer. One Team.

8 September 2011

Daniela Vujic
Planning Assessment Manager
Sydney Ports Corporation
Level 4, 20 Windmill Street
WALSH BAY NSW 2000

Dear Daniela

Re: Request for Additional Information - Your Ref: C11/1152

- Swept path drawing (A2066-SK12-A.pdf, attached), supplied drawing was a preliminary one, which actually has a tighter turn left back to the terminal, than current drawings.
- The maximum excavation depth will be for the conduit going underneath the crane rail (section 3 on drawing A2066 C320, previously supplied); this will be to a depth of 1.5 meters. The Patrick Terminal is a tide affected site such that the ground water table is effectively the mean high water mark. The surveyed contours for the weigh bridge area, RL's varies from 3.8 to 4.0 meters.
- The current civil programme runs to 15 weeks, when does the Sydney Ports Corporation intend on approving this submission? After construction trucks enter the terminal via the same entrance as the container trucks, they are directed to a manned security demountable, and then escorted to their work area - refer "Construction Access Mark up drawing A2066-C301-1.pdf", attached.
- Development Code
 - These works consist simply of line marking, no civil works needs be done, and the roadways, signage and walkways referred to are implemented by line marking on a large asphalt area. The drawing associated, is included in the last page of the Hazard Identification Questionnaire (previously supplied). Confirming works to be undertaken in accordance with the Development Code.
 - Confirming that the proposed drainpipes from the weigh bridge facility will drain to an existing stormwater pit which includes a treatment device.
- Summary: see over

Yours sincerely

Scott Forster

Sydney Terminal Manager



Patrick Stevedores Operations Pty Limited
ABN 33 065 375 840

PO Box 197
Botany NSW 1455

Penrhyn Road
Port Botany NSW 2019

Telephone: 61 2 9394 0300
Facsimile: 61 2 9394 0395

www.patrick.com.au

3.3 Mitigation Measures

Given the low impact of the proposed development specific mitigation measures in relation to stormwater runoff, visual impacts, odour, etc are not required during the operational phase. Mitigation measures are proposed to ensure the suppression of dust, sediment and erosion control via water cart, house keeping (bobcat with broom attachment) and those outlined in Drawing 21-12475-99C023.

It should be noted that the construction phase will occur during the expansion of other port facilities and the incremental impacts are viewed as minimal And within the limits imposed by existing development consents for the site.

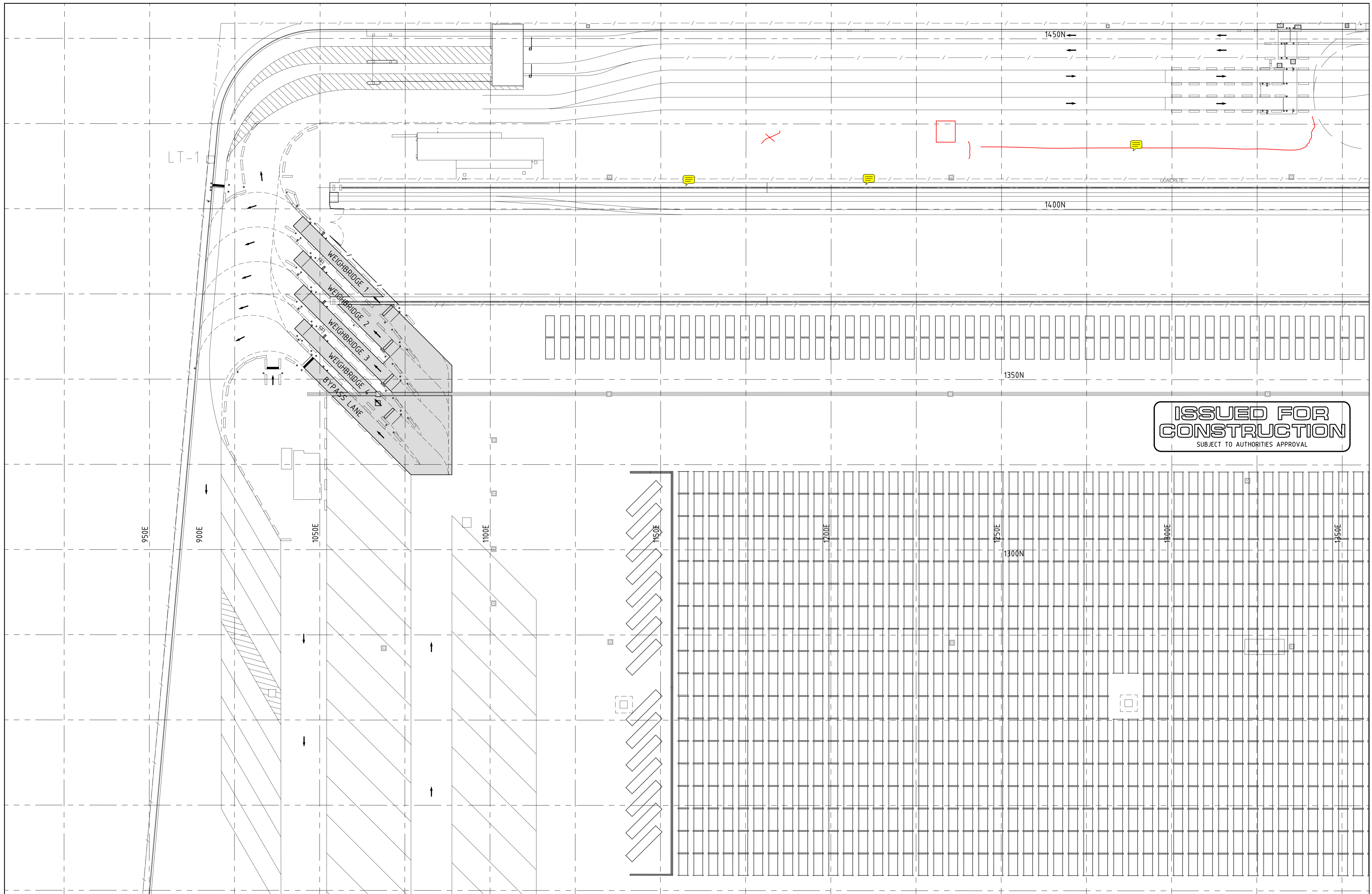

ISSUED FOR CONSTRUCTION
SUBJECT TO AUTHORITIES APPROVAL

REV.	BY	DATE	DETAILS	REV.	BY	DATE	DETAILS
1	RSB	25.07.11	GENERAL REVISION				
0	RSB	08.06.11	ISSUED FOR CONSTRUCTION				
A	RSB	28.04.11	ISSUED FOR TENDER				
AMENDMENTS				AMENDMENTS			

Contractor shall check and verify all dimensions and levels on site before commencing any work.
Use figured dimensions ONLY.
DO NOT SCALE DRAWING
THIS DRAWING IS PROTECTED BY COPYRIGHT

DOCUMENT APPROVAL	
SIGNATURE	DATE
GILLON CONSULTING GROUP PTY LTD	25.07.11

CLIENT
PATRICK Terminals
PORT BOTANY CONTAINER TERMINAL
PENRHYN ROAD
PORT BOTANY NSW 2019

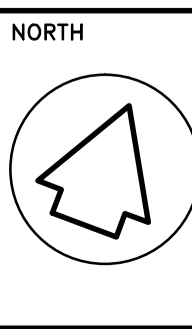

PROJECT TITLE
PORT BOTANY
NEW WEIGHBRIDGE
INSTALLATION
DRAWING TITLE
NEW WEIGHBRIDGE
SITE LAYOUT PLAN

GILLON CONSULTING GROUP PTY LTD			
CONSULTING ENGINEERS AND MANAGERS			
CIVIL/STRUCTURAL/MARINE A.C.N. 079 056 161			
LEVEL 1, 38 AHERTON ROAD, OAKLEIGH 3166			
TEL. (03) 9564 8233 FAX. (03) 9564 8244			
Email: mail@gillonconsulting.com.au			
DRAWN RSB	DESIGNED KB	DATE APRIL 2011	DRAWING No. A2066 C301
A1 SCALE 1:500	ACONEX REF. No.		REV. 1
A3 SCALE 1:1000	PBWB-GIL-CIV-A2066-C301		

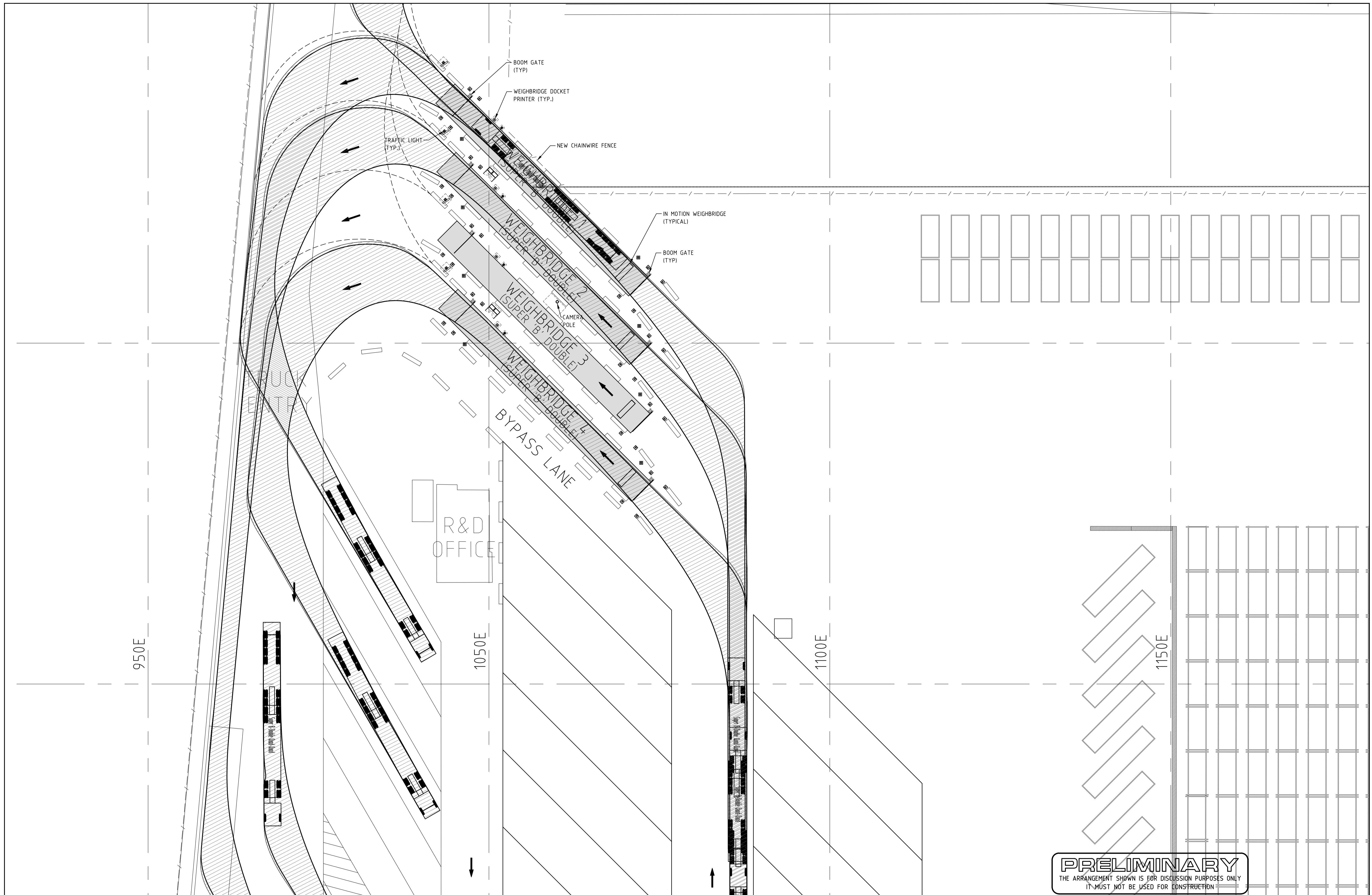

PRELIMINARY
 THE ARRANGEMENT SHOWN IS FOR DISCUSSION PURPOSES ONLY
 IT MUST NOT BE USED FOR CONSTRUCTION

REV.	BY	DATE	DETAILS
A	RSB	14.04.11	PRELIMINARY ISSUE
AMENDMENTS			

REV.	BY	DATE	DETAILS
AMENDMENTS			

Contractor shall check and verify all dimensions and levels on site before commencing any work.
 Use figured dimensions ONLY.
 DO NOT SCALE DRAWING
THIS DRAWING IS PROTECTED BY COPYRIGHT

DOCUMENT APPROVAL	
SIGNATURE	DATE
GILLON CONSULTING GROUP PTY LTD	

CLIENT
PATRICK Terminals
 PORT BOTANY CONTAINER TERMINAL
 PENRHYN ROAD
 PORT BOTANY NSW 2019

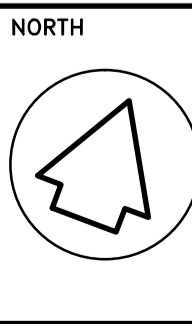

PROJECT TITLE
 PORT BOTANY
 NEW WEIGHBRIDGE
 INSTALLATION
 DRAWING TITLE
 OPTION 1
 GENERAL ARRANGEMENT PLAN
 SHOWING TRUCK PATHS

GILLON CONSULTING GROUP PTY LTD CONSULTING ENGINEERS AND MANAGERS CIVIL/STRUCTURAL/MARINE A.C.N. 079 056 161 LEVEL 11, 38 AHERTON ROAD, OAKLEIGH 3166 TEL: (03) 9564 8233 FAX: (03) 9564 8244 Email: mail@gillonconsulting.com.au			
DRAWN RSB	DESIGNED -	DATE APRIL 2011	REV. A
A1 SCALE 1:250 A3 SCALE 1:500		ACONEX REF. No.	DRAWING No. A2066 SK12